

BLUEFIX Two-material plastic anchor

Technical Data Sheet update to **16.02.2017** / pag. 1 of 1

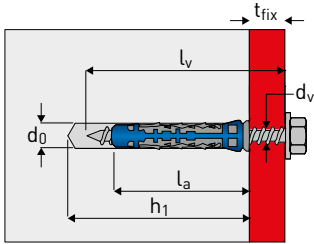

TWO-MATERIAL HIGH STRENGTH PLASTIC ANCHOR FOR USE IN SOLID AND HOLLOW BASE MATERIAL

TECHNICAL DATA									
DIMENSIONS	Embedment depth	Fixture thickness	Drilling depth	Base material thickness	Ø screw thread	Ø drilling	Total length	Tightening torque	
	mm	mm	mm	mm	mm	mm	mm	Nm	
	h_{ef}	t_{fix}	h_1	h_{min}	d_s	d_0	l_a	T_{inst}	CODICE
6x35	38		50	80	3,5-4,5	6	35	1,1-1,9	568286
6x35/VA		≤10	50		4,5x50	6	35		565540
6x35/KS		≤10	50		4,5x45	6	35		568179
8x50	50		65	80	4,5-6,0	8	50	3,0	568287
8x50/VA		≤10	65		5,0x60	8	50		565541
8x50 HS	50	5	65	80	5,0x60	8	50	3,0	568172

APPLICATIONS

Light-duty application
 Light shelves fixing and restraint
 Equipment and lighting
 Furniture

MATERIALS

Nylon PA6.6 T.E.I.M.
 Nylon PA6 FG-B 10

FIELD OF USE

Setting temperature: -0°C ÷ +40°C
 Service temperature: -20°C ÷ +70°C

FEATURES



BLUEFIX Ø8 is seismic test

INSTALLATION

Drill the hole with the recommended diameter and clean the hole

Set the anchor sleeve inside the hole

Tight the screw up to the fixture surface by using the perscribed tightening torque

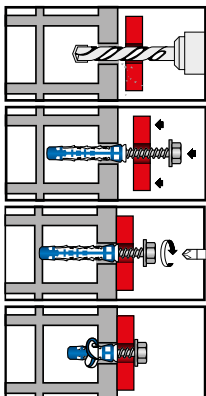

Ultimate loads ($N_{Ru,m}$, $V_{Ru,m}$)

Dimensions	TENSION [daN]		SHEAR [daN]	
	Ø6	Ø8	Ø6	Ø8
Embedment depth	38	50	38	50
Concrete C20/25	188,7	230,9	-	-
Solid brick	170	220	-	-
Hollow clay brick	135	200	-	281,3
Hollow concrete block	150	210	-	-
Aerated concrete AAC 5	69,3	103,9	-	-
Single gypsum panel 13mm	49,3	56,1	-	-
Twin gypsum panel 26mm	63,8	106,7	-	-

Reccomended loads (N_{Rec} , V_{Rec})

Dimensions	TENSION [daN]		SHEAR [daN]	
	Ø6	Ø8	Ø6	Ø8
Embedment depth	38	50	38	50
Concrete C20/25	37,7	46,2	-	-
Solid brick	34	44	-	-
Hollow clay brick	27	40	-	56,3
Hollow concrete block	30	42	-	-
Aerated concrete AAC 5	13,9	20,8	-	-
Single gypsum panel 13mm	9,9	11,2	-	-
Twin gypsum panel 26mm	12,8	21,3	-	-